

EXTRA LOW VOLTAGE DOWNLIGHT WITH MESH COVER

Metal ventilated mesh downlight cover to minimize insulation clearances.

- Reduces insulation clearance distance*
- Mesh assists in preventing loose flammable material coming into contact with the lamp.
- 60VA Nelson Cougar electronic transformer included.
- 50W MR16 Aluminium backed lamp included.
- Available in White, Brush Chrome, Fixed and Gimble fixtures.



MALC317WHMCK



MALC515WHMCK



MR16 50W 12V

MATERIALS/FINISH

Cast alloy painted white
High temperature powder coat finish
Perforated mesh downlight cover

INPUT VOLTAGE

220-240V~50Hz

For replacement lamp use Nelson's MR16 lamp (MAEXNCPB)

Product Code	Dimensions	
	Diameter	Cutout Hole
MALC317	80mm	67mm
MALC515	105mm	86mm

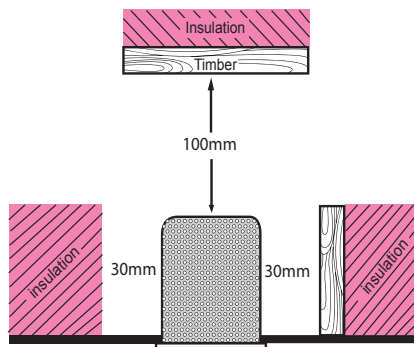

SPECIFICATION GUIDE		
Product	Product Description	Lamp Wattage
MALC317WHMCK	Extra Low Voltage Fixed downlight with mesh cover, White	50W
MALC515WHMCK	Extra Low Voltage Gimble downlight with mesh cover, White	50W
MALC317BCMCK	Extra Low Voltage Fixed downlight with mesh cover, Brush Chrome	50W
MALC515BCMCK	Extra Low Voltage Gimble downlight with mesh cover, Brush Chrome	50W

NELSON MESH DOWNLIGHT COVER

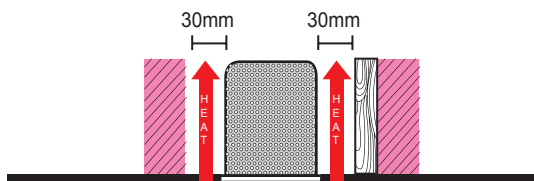

CONVENTIONAL DOWNLIGHT

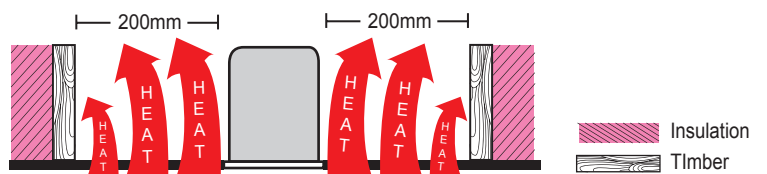

*Reduces insulation clearance distance to 30mm around cover and 100mm above cover. These products have been tested with a Nelson's aluminium reflector backed lamp (MAEXNCPB) successfully to AS/NZS60598.2.2:2001 and complies with Wiring Rules AS/NZS3000:2007, Recessed luminaires, clause 4.5.2.3 method (b).

NOTE: All specifications correct at time of printing. Specifications are subject to change without notice.

Customer Service:
1300 369 777

A Group brand | legrand

